

LANDSCAPING/SITE PLAN

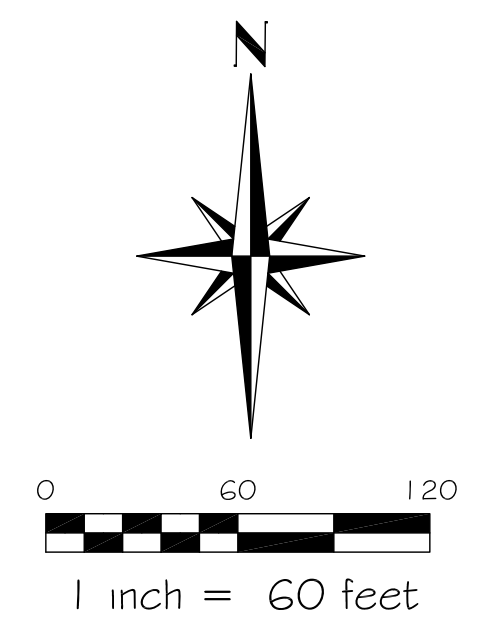
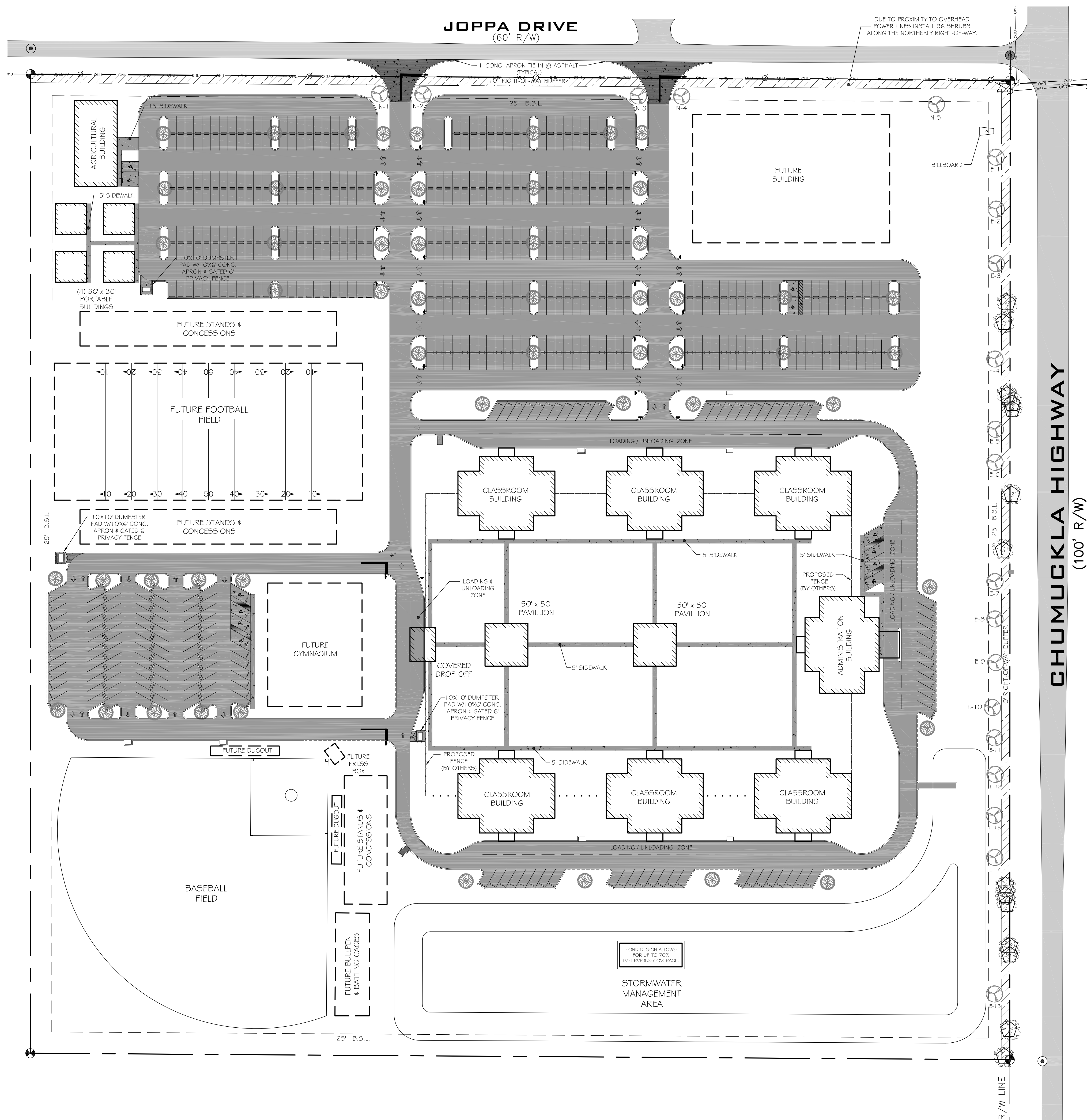

THE CONTRACTOR SHOULD COORDINATE WITH THE COMMUNITY PLANNING, ZONING AND DEVELOPMENT DIVISION PRIOR TO PURCHASING OR INSTALLING LANDSCAPING TO DETERMINE CREDIT FOR EXISTING VEGETATION TO (PARTIALLY) MEET THE LANDSCAPING REQUIREMENTS SHOWN ON THIS PLAN.

NOTE:
 1. EX. VEGETATION MAY BE UTILIZED TO MEET BUFFER REQUIREMENTS. PRIOR TO ORDERING ANY PLANT MATERIAL CONTACT S.R.C. PLANNING & ZONING OFFICE TO SCHEDULE SITE INSPECTION.
 2. SEE PLANT TABLE LOCATED ON SHEET 3A FOR ALL PLANTING SPECIES REQUIRED IN THIS LANDSCAPE BUFFER.

PARKING AREA LANDSCAPE PLANTING

PARKING LOT REQUIREMENTS
 1 NEW TREE PER 12 PARKING SPACES = TOTAL NUMBER OF TREES
 642 TOTAL PARKING SPACES / 12 = 53.5 OR 54 TREES REQUIRED.

- NEW TREES REQUIRED = 54 TREES
 18 LIVE OAKS, 18 SOUTHERN MAGNOLIAS, 18 RED MAPLES TO BE PLANTED.

10' WIDE PERIMETER LANDSCAPE STRIP

- 10' WIDE PERIMETER LANDSCAPE STRIP ADJACENT TO ALL RIGHTS-OF-WAY.
 1 TREE PER 40 L.F. OF US BUFFER

NEW TREE #

EAST: CHUMUCKLA HIGHWAY
 1,144 +/- L.F. OF US STRIP
 1,144 L.F. OF US STRIP / 40 = 28.6 OR 29 TREES REQUIRED.
 14 EXISTING TREES WITHIN LANDSCAPE STRIP
 15 NEW TREES ARE PROPOSED.

NORTH: JOPPA DRIVE
 1,144 +/- L.F. OF RIGHT-OF-WAY FRONTAGE - 46' ENTRANCE WIDTH
 1,096 +/- L.F. OF US STRIP
 1,096 L.F. OF US STRIP / 40 = 27.4 OR 28 TREES REQUIRED.
 5 NEW TREES & 96 SHRUBS ARE PROPOSED.

PRIOR TO CONSTRUCTION:
 CONTRACTOR MUST OBTAIN A UTILITY PERMIT FROM SANTA ROSA COUNTY ROAD & BRIDGE PRIOR TO WORK WITHIN THE COUNTY RIGHT-OF-WAY.



CONTRACTOR SHALL CONTACT SUNSHINE UTILITIES 48 HOURS PRIOR TO CONSTRUCTION WITHIN THE RIGHT-OF-WAY.

Construction Plans for:
**L.E.A.D. ACADEMY
 CLASSICAL SCHOOL**

SOUTHERN SITE & UTILITY DESIGN, INC.
 FLORIDA CERTIFICATE OF AUTHORITY NO. 8983
 6555 CAROLINE STREET - MILTON, FLORIDA 32570
 PH: (850) 623-9493 E-MAIL: ssud@bellsouth.net
 EROSION CONTROL PLANS - POTABLE WATER & SANITARY SEWER
 SITE PLANS - SUBDIVISIONS - STORMWATER MANAGEMENT

DRAWN BY: P.R.P. DATE: 1/17/2017
 REVISIONS:
 1. _____
 2. _____
 3. _____
 4. _____

DATE: _____
 PAUL A. MCLEOD, JR., P.E.
 FL LICENSE NO. 58629
 A.JAN M. MILLER, P.E.
 FL LICENSE NO. 55577
 DRAWING NOT VALID UNLESS SIGNED AND SEALED BY ENGINEER OF RECORD